

6

5

4

3

2

1

MATERIAL: CuZn, Silver plated



ACCESSORIES:

CRIMP TOOL FOR CONTACTS:  
P/N: PD-HEC-CT

SIGNAL CONTACT EXTRACTION TOOL:  
P/N: PD-HEC-SCET

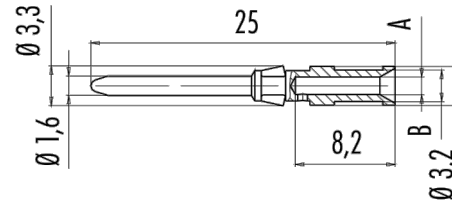
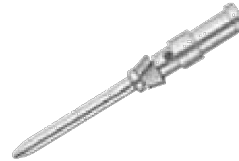

REV	DATE	CHNG	CHK	APPR

P/N	AWG / mm <sup>2</sup>	A	B
PD-HEC-MSC-16	16 / 1.5	1.8	3.0
PD-HEC-MSC-18	18 / 0.75 - 1.0	1.45	2.6
PD-HEC-MSC-20	20 / 0.5	1.1	2.6
PD-HEC-MSC-26	26 - 22 / 0.14 - 0.34	0.9	2.6

TOLERANCE UNLESS OTHERWISE SPECIFIED	
X	± 1
X.X	± 0.4
X.XX	± 0.13
DRAWN BY	PB
DATE:	7/28/14
CHECK BY	
DATE:	
APPR BY	
DATE:	

**Power Dynamics, Inc.**  
 Phone: 973 560-0019 Whippany, New Jersey Fax: 973 560-0076

PART: HARSH ENVIRONMENT CONNECTOR  
 MALE SIGNAL CONTACT

**PD-HEC-MSC-XX**

SIZE: A  
 SCALE: NTS

ALL DIMENSIONS FOR REFERENCE ONLY  
 DIMENSIONS ARE IN MILLIMETERS

SHEET 1 of 1  
 REV:

6

5

4

3

2

1